

Environmental Compliance Workshop

Sample Submission Packet

Christine Heacock
Deputy Federal Preservation Officer
November 02, 2023



* This presentation and its contents are for informational purposes only; the Commission's rules in part 47 of the Code of Federal Regulations and the Commission's previous reports and orders adopting those rules represent the binding rules and determinations of the Commission.

General Information

The Applicant is the licensee or tower builder. They will have a different FRN than the consultant.



Please fill this out completely and ensure that the person listed is available via the contact information provided on the form.



General Information

1) (Select only one) (NE) NE - New UA - Update of Application WD - Withdrawal of Application	
2) If this application is for an Update or Withdrawal, enter the file number of the pending application currently on file.	File Number:

Applicant Information

3) FCC Registration Number (FRN): 0123456789	
4) Name: C and O Cellular Company	

Contact Name

5) First Name: Oscar	6) MI:	7) Last Name: Jones	8) Suffix:
9) Title: Project Manager			

Contact Information

10) P.O. Box:	And /Or	11) Street Address: 45 L Street NE	
12) City: Washington		13) State: DC	14) Zip Code: 20554
15) Telephone Number: (888) 225-5322		16) Fax Number: ()	
17) E-mail Address: ojones@coandocell.com			

Consultant Information

18) FCC Registration Number (FRN): 3456789123	
19) Name: M and M Environmental Consultants,, Inc	

Principal Investigator

20) First Name: Max	21) MI:	22) Last Name: Smith	23) Suffix:
24) Title: Principle Investigator			

Principal Investigator Contact Information

25) P.O. Box:	And /Or	26) Street Address: 456 Main Street	
27) City: Springfield		28) State: LA	29) Zip Code: 70001
30) Telephone Number: (318) 789-1234		31) Fax Number: ()	
32) E-mail Address: msmith@mandmconsult.com			

Consultant Qualifications

Even if the Principal Investigator does not meet the Secretary of Interior (SOI) Qualification Standards, there should be someone on the form who does.

Note: There are certain provisions within the Wireless Facilities Nationwide Programmatic Agreement (NPA) that state which tasks **MUST** be completed by a professional who meets the SOI standards.
(NPA at Sections: VI.D.1.e, VI.D.2.b, VI.E.5)



Professional Qualification

33) Does the Principal Investigator satisfy the Secretary of the Interior's Professional Qualification Standards?	(<input checked="" type="checkbox"/>) Yes () No
34) Areas of Professional Qualification:	
(<input checked="" type="checkbox"/>) Archaeologist	
() Architectural Historian	
() Historian	
() Architect	
() Other (Specify) _____	

Additional Staff

35) Are there other staff involved who meet the Professional Qualification Standards of the Secretary of the Interior?	(<input checked="" type="checkbox"/>) Yes () No
--	--

If "Yes", complete the following:

36) First Name: Manny	37) MI:	38) Last Name: Williams	39) Suffix:
40) Title: Architectural Historian			
41) Areas of Professional Qualification:			
() Archaeologist			
(<input checked="" type="checkbox"/>) Architectural Historian			
() Historian			
() Architect			
() Other (Specify) _____			

This page may be copied to include additional staff.
Consultant Information Attachments required – See instructions for details.

Site Information

Ensure that the project is tied to a TCNS number!

Please fill out a description of the project that clearly conveys the proposed work.

*Keep in mind that these are generally desktop reviews on the part of the State Historic Preservation Officers (SHPO)/Tribal Historic Preservation Officers (THPO) and/or FCC (when appropriate). In most cases, reviewers have not visited the site, but the consultant has. The more detail that can be included here, the better!

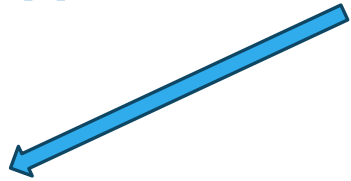

Tower Construction Notification System		Site Information
1) TCNS Notification Number: 123456		
Site Information		
2) Positive Train Control Filing Subject to Expedited Treatment Under Program Comment: () Yes (<input checked="" type="checkbox"/>) No		
3) Site Name:		
4) Site Address: 123 W Country Road		
5) Detailed Description of Project: Proposed self-support lattice tower. 199 feet overall height including appurtenances.		
6) City: Greenfield	7) State: LA	8) Zip Code: 70005
9) County/Borough/Parish:		
10) Nearest Crossroads:		
11) NAD 83 Latitude (DD-MM-SS.S): 30°27'22.1" (<input checked="" type="checkbox"/>) N or () S		
12) NAD 83 Longitude (DD-MM-SS.S): 91°53'02.0" () E or (<input checked="" type="checkbox"/>) W		
Tower Information		
13) Tower height above ground level (include top-mounted attachments such as lightning rods): 199 () Feet () Meters		
14) Tower Type (Select One): () Guyed lattice tower (<input checked="" type="checkbox"/>) Self-supporting lattice () Monopole () Other (Describe):		
Project Status		
15) Current Project Status (Select One): (<input checked="" type="checkbox"/>) Construction has not yet commenced () Construction has commenced, but is not completed Construction commenced on: ___/___/___ () Construction has been completed Construction commenced on: ___/___/___ Construction completed on: ___/___/___		

Site Information Attachments required – See instructions for details.

Determination of Effect

For FCC undertakings, there are two Areas of Potential Effect (APEs):

- Direct Effects
- Indirect Effects

(also referred to as Visual Effects)

Note: The determination of effect should match throughout E106 System and all supporting materials in the submission packet.

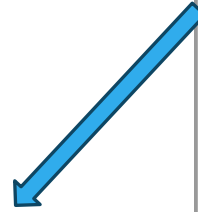

Determination of Effect

16) Direct Effects (Select One):

- No Historic Properties In Area of Potential Effects (APE)
 No Effect on Historic Properties In APE
 No Adverse Effect on Historic Properties In APE
 Adverse Effect on one or more Historic Properties In APE

17) Visual Effects (Select One):

- No Historic Properties In Area of Potential Effects (APE)
 No Effect on Historic Properties In APE
 No Adverse Effect on Historic Properties In APE
 Adverse Effect on one or more Historic Properties In APE

Determination of Effect Attachments required – See instructions for details.

Tribal/Native Hawaiian Organization Involvement

Tribes should be contacted via their preferred means of communication.

Tribes have a right to seek government-to-government consultation in which they work directly with FCC staff.

As a general note: when a Tribe indicates an adverse impact, requests monitoring, or indicates that significant sites may be impacted, please do not stop communicating with them (unless they've requested government-to-government consultation).

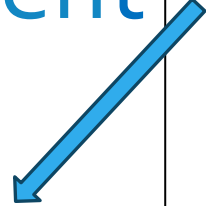

Tribal/NHO Involvement			
1) Have Indian Tribes or Native Hawaiian Organizations (NHOs) been identified that may attach religious and cultural significance to historic properties which may be affected by the undertaking within the APEs for direct and visual effects?			(<input checked="" type="checkbox"/>) Yes (<input type="checkbox"/>) No
2a) Tribes/NHOs contacted through TCNS Notification Number: <u>123456</u>		Number of Tribes/NHOs: <u>4</u>	
2b) Tribes/NHOs contacted through an alternate system:		Number of Tribes/NHOs:	
Tribal/NHO Contacted Through TCNS			
3) Tribe/NHO FRN:			
4) Tribe/NHO Name: <u>Tribe Name</u>			
Contact Name			
5) First Name: <u>John</u>	6) MI:	7) Last Name: <u>Richards</u>	8) Suffix:
9) Title: <u>Tribal Historic Preservation Officer</u>			
Dates & Response			
10) Date Contacted <u>8 / 21 / 23</u>		11) Date Replied <u> </u> / <u> </u> / <u> </u>	
(<input type="checkbox"/>) No Reply			
(<input type="checkbox"/>) Replied/No Interest			
(<input type="checkbox"/>) Replied/Have Interest			
(<input type="checkbox"/>) Replied/Other _____			

This page may be copied to include additional Tribes/NHOs contacted.
Tribal/NHO Involvement Attachments may be required – See instructions for details.

Historic Properties

- Identify all historic properties in the APEs.
- Note: if there are more than 10 historic properties in the APEs, you are required to attach a Cultural Resources Report instead of listing the historic properties on the Form 620/621.

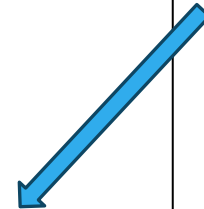

Historic Properties	
Properties Identified	
1) Have any historic properties been identified within the APEs for direct and visual effect?	(<input checked="" type="checkbox"/>)Yes ()No
2) Has the identification process located archaeological materials that would be directly affected, or sites that are of cultural or religious significance to Tribes/NHOs?	()Yes (<input checked="" type="checkbox"/>)No
3) Are there more than 10 historic properties within the APEs for direct and visual effect? If "Yes", you are required to attach a Cultural Resources Report in lieu of adding the Historic Property below.	()Yes (<input checked="" type="checkbox"/>)No
Historic Property	
4) Property Name: Historic Farm House	
5) SHPO Site Number:	
Property Address	
6) Street Address: 456 Country Road	
7) City: Greenfield	8) State: LA 9) Zip Code: 70005
10) County/Borough/Parish:	
Status & Eligibility	
11) Is this property listed on the National Register? Source: _____	()Yes (<input checked="" type="checkbox"/>)No
12) Is this property eligible for listing on the National Register? Source: LA SHPO Records	(<input checked="" type="checkbox"/>)Yes ()No
13) Is this property a National Historic Landmark?	()Yes (<input checked="" type="checkbox"/>)No
14) Direct Effects (Select One): (<input checked="" type="checkbox"/>) No Effect on this Historic Property In APE () No Adverse Effect on this Historic Property In APE () Adverse Effect on this Historic Property In APE	
15) Visual Effects (Select One): (<input checked="" type="checkbox"/>) No Effect on this Historic Property In APE () No Adverse Effect on this Historic Property In APE () Adverse Effect on this Historic Property In APE	

This page may be copied to include additional Historic Properties.
Historic Property Attachments required – See instructions for details.

Local Government Involvement

Local governments are consulting parties by right in the Section 106 process.

Section V.A of the NPA: "On or before the date an Applicant submits the appropriate Submission Packet to the SHPO/THPO...the Applicant shall provide the local government that has primary land use jurisdiction over the site of the planned Undertaking with written notification of the planned Undertaking."

The written notice to the local government and to the public shall include (Section V.C. of the NPA):

- (1) The location of the proposed Facility including its street address;
- (2) a description of the proposed Facility including its height and type of structure;
- (3) instruction on how to submit comments regarding potential effects on Historic Properties; and
- (4) the name, address, and telephone number of a contact person.

Local Government Involvement

Local Government Agency

1) FCC Registration Number (FRN):

2) Name: **Town of Greenfield**

Contact Name

3) First Name: **Martin**

4) MI:

5) Last Name: **Doyle**

6) Suffix:

7) Title: **Planner**

Contact Information

8) P.O. Box:

And /Or

9) Street Address: **222 Main Street**

10) City: **Greenfield**

11) State: **LA**

12) Zip Code: **70002**

13) Telephone Number: ()

14) Fax Number: ()

15) E-mail Address:

16) Preferred means of communication:

() E-mail

() Letter

() Both

Dates & Response

17) Date Contacted 08/21 / 23

18) Date Replied ___ / ___ / ___

() No Reply

() Replied/No Interest

() Replied/Have Interest

() Replied/Other _____

Additional Information

19) Information on local government's role or interest (optional):

This page may be copied to include additional local government agencies.
Local Government Attachments required – See instructions for details.

Other Consulting Parties

Section V.D of the NPA states:

“A SHPO/THPO may make available lists of other groups, including Indian tribes, NHOs and organizations of Indian tribes or NHOs, which should be provided notice for Undertakings to be located in particular areas.”

Section V.G.1-2

“Consulting parties are entitled to:

- (1) Receive notices, copies of submission packets, correspondence and other documents provided to the SHPO/THPO in a Section 106 review; and
- (2) be provided an opportunity to have their views expressed and taken into account by the Applicant, the SHPO/THPO and, where appropriate, by the Commission.”

Other Consulting Parties			
Other Consulting Parties Contacted			
1) Has any other agency been contacted and invited to become a consulting party?			(<input checked="" type="checkbox"/>) Yes (<input type="checkbox"/>) No
Consulting Party			
2) FCC Registration Number (FRN):			
3) Name: Greenfield Historical Society			
Contact Name			
4) First Name: Joan	5) MI:	6) Last Name: Mullins	7) Suffix:
8) Title: President			
Contact Information			
9) P.O. Box:	And /Or	10) Street Address:	
11) City:		12) State:	13) Zip Code:
14) Telephone Number: ()		15) Fax Number: ()	
16) E-mail Address:			
17) Preferred means of communication:			
() E-mail			
(<input checked="" type="checkbox"/>) Letter			
() Both			
Dates & Response			
18) Date Contacted 8 / 21 / 23		19) Date Replied ____ / ____ / ____	
() No Reply			
() Replied/No Interest			
() Replied/Have Interest			
() Replied/Other _____			
Additional Information			
20) Information on other consulting parties' role or interest (optional):			

This page may be copied to include additional consulting parties.
Consulting Parties Attachments required – See instructions for details.



Pages on the Form 621

Tower Construction Notification System			Site Information
1) TCNS Notification Number: <u>234567</u>			
Site Information			
2) Positive Train Control Filing Subject to Expedited Treatment Under Program Comment: () Yes (<input checked="" type="checkbox"/>) No			
3) Site Name: Water Tank Collocation			
4) Site Address: 456 E Cove Street			
5) Detailed Description of Project: C and O Cellular Company proposes to add antennas to an existing water tank at a centerline height of 125' for an overall height of 132'3".			
6) City: Greenfield	7) State: LA	8) Zip Code: 70005	
9) County/Borough/Parish: St. Martin Parish			
10) Nearest Crossroads:			
11) NAD 83 Latitude (DD-MM-SS.S): 30°14'39.8"		(<input checked="" type="checkbox"/>) N or () S	
12) NAD 83 Longitude (DD-MM-SS.S): 91°46'06.7"		() E or (<input checked="" type="checkbox"/>) W	
Collocation Information			
13) Antennas will be located on (Select One): () Communications Tower (Select One): () Guyed Lattice Tower () Self-supporting Lattice () Monopole () Other (Describe): _____ (<input checked="" type="checkbox"/>) Non-Tower Structure (Describe Structure): TANK - Any type of Tank (Water, Gas, etc)			
14) Tower height above ground level (including top-mounted attachments such as lightning rods): 40.3 () Feet (<input checked="" type="checkbox"/>) Meters			
15) Description of Antennas to be collocated (e.g. number, type, shape, dimensions, color): 3 proposed panel antennas on the north side of the guardrail at a centerline height of 125 feet.			
16) Will the Antennas be placed at multiple levels on the structure? If "Yes", describe placement: _____ If "No", specify the height of collocation above ground: 125 (<input checked="" type="checkbox"/>) Feet () Meters			() Yes (<input checked="" type="checkbox"/>) No
17) Structure Completion Year: 1955 (YYYY) (<input checked="" type="checkbox"/>) Check here if your year provided is approximate.			

18) Has the Communications Tower or Non-Tower Structure been the subject of SHPO/THPO review? If "Yes", specify the following: Company that made the submission: _____ Date submitted: ____/____/____ SHPO/THPO Reference Number: _____		() Yes (<input checked="" type="checkbox"/>) No
19) Is the Communications Tower or Non-Tower Structure eligible for listing on the National Register?		() Yes (<input checked="" type="checkbox"/>) No
Site Information Attachments required - See instructions for details.		

These pages differ from the Form 620

Pages on the Form 621

- Clearly indicate whether construction has started. 
- Ensure the determination of effect is consistent throughout the form. 

Collocation Status

20) Current Collocation Status (Select One):

- Construction and/or installation has not yet commenced
- Construction and/or installation has commenced, but is not completed
Construction and/or installation commenced on: ___/___/___
- Construction has been completed
Construction and/or installation commenced on: ___/___/___ Construction and/or installation completed on: ___/___/___

Determination of Effect

21) Direct Effects (Select One):

- No Historic Properties In Area of Potential Effects (APE)
- No Effect on Historic Properties In APE
- No Adverse Effect on Historic Properties In APE
- Adverse Effect on one or more Historic Properties In APE

22) Visual Effects (Select One):

- No Historic Properties In Area of Potential Effects (APE)
- No Effect on Historic Properties In APE
- No Adverse Effect on Historic Properties In APE
- Adverse Effect on one or more Historic Properties In APE

Determination of Effect Attachments required – See instructions for details.

Designation of SHPO/THPO

- Designate the appropriate SHPO's office or THPO for the undertaking.
- By signing this form, the applicant certifies that the statements listed in this section are true, complete, correct, and made in good faith.

Designation of SHPO/THPO

1) Designate the Lead State Historic Preservation Officer (SHPO) or Tribal Historic Preservation Officer (THPO) based on the location of the tower.

SHPO/THPO

Name: Office of Cultural Development

2) You may also designate up to three additional SHPOs/THPOs if the APEs include multiple states. If the APEs include other countries, enter the name of the National Historic Preservation Agency and any state and provincial Historic Preservation Agency.

SHPO/THPO Name: _____

SHPO/THPO Name: _____

SHPO/THPO Name: _____

Designation of SHPO/THPO Attachments may be required – See instructions for details.

Certification

I certify that all representations on this FCC Form 620 Submission Packet and the accompanying attachments are true, correct, and complete.

Party Authorized to Sign

First Name: Max	MI:	Last Name: Smith	Suffix:
Signature: Max Smith			Date: <u>09/16/23</u>

FAILURE TO SIGN THIS APPLICATION MAY RESULT IN DISMISSAL OF THE APPLICATION AND FORFEITURE OF ANY FEES PAID.

WILLFUL FALSE STATEMENTS MADE ON THIS FORM OR ANY ATTACHMENTS ARE PUNISHABLE BY FINE AND/OR IMPRISONMENT (U.S. Code, Title 18, Section 1001) AND/OR REVOCATION OF ANY STATION LICENSE OR CONSTRUCTION PERMIT (U.S. Code, Title 47, Section 312(a)(1)), AND/OR FORFEITURE (U.S. Code, Title 47, Section 503).

Attachments

- Attachments to the Form 620/621 are the most frequently incomplete components of a submission packet.
- Parties should submit all required information for each submission packet to include maps and photographs.
- Please ensure all information provided makes the undertaking clear to a reviewer.
- Please reference the guidance found on the Tower and Antenna Siting Page. <https://www.fcc.gov/wireless/bureau-divisions/competition-infrastructure-policy-division/tower-and-antenna-siting>



Resumes

- Resumes should clearly demonstrate that professionals meet the Secretary of Interior Standards for those aspects of the Section 106 process specified in the NPA that require this qualification.
 - Note: Discussions with SHPO staff do not eliminate the need for a qualified professional to apply the criteria of adverse effect on behalf of the applicant.

Photographs

- Photograph Requirements
 - Except in cases where no historic properties were identified
 - Photographs should be in color, marked to identify the project, keyed to the relevant map, and dated.
 - Photos taken from the tower site should show views from the proposed location in all directions, with each direction identified in the caption.
 - If there are eligible or listed historic properties in the APE, photograph them.
 - If any historic properties are visible from the proposed site, please submit photographs looking at the site from each historic property along with approximate distance.
- Do not use Google Street view to substitute for photographs
 - SHPOs/THPOs, Tribes, Consulting Parties, and FCC staff rely on the accuracy of photographs to understand the physical context of the proposed tower or collocation.
 - In certain circumstances (i.e., where obtaining a photo is difficult for safety reasons) Google Street View may be acceptable. However, in the majority of circumstances, a photograph is feasible.

Google Maps vs. Photographs

Accessed On Google Maps August
2023 (view as of May 2021):



Photograph Taken August 2023



Map Requirements

- Include one or more 7.5-minute quad U.S. Geological Survey (USGS) topographical maps that:
 - Identify the Areas of Potential Effects for both Direct and Visual Effects. If a map is copied from the original, include a key with name of quad and date.
 - Show the location of the proposed tower site and any new access roads or other easements including excavations.
 - Show the locations of each property listed.
 - Include keys for any symbols, colors, or other identifiers.
 - Submit color maps whenever possible.

Area of Potential Effects

- Areas of Potential Effect Guidelines:
 - Describe the APE for direct effects and explain how this APE was determined.
 - Describe the APE for visual effects and explain how this APE was determined.
- Clearly illustrate the areas of potential effect.

APE for Direct Effects

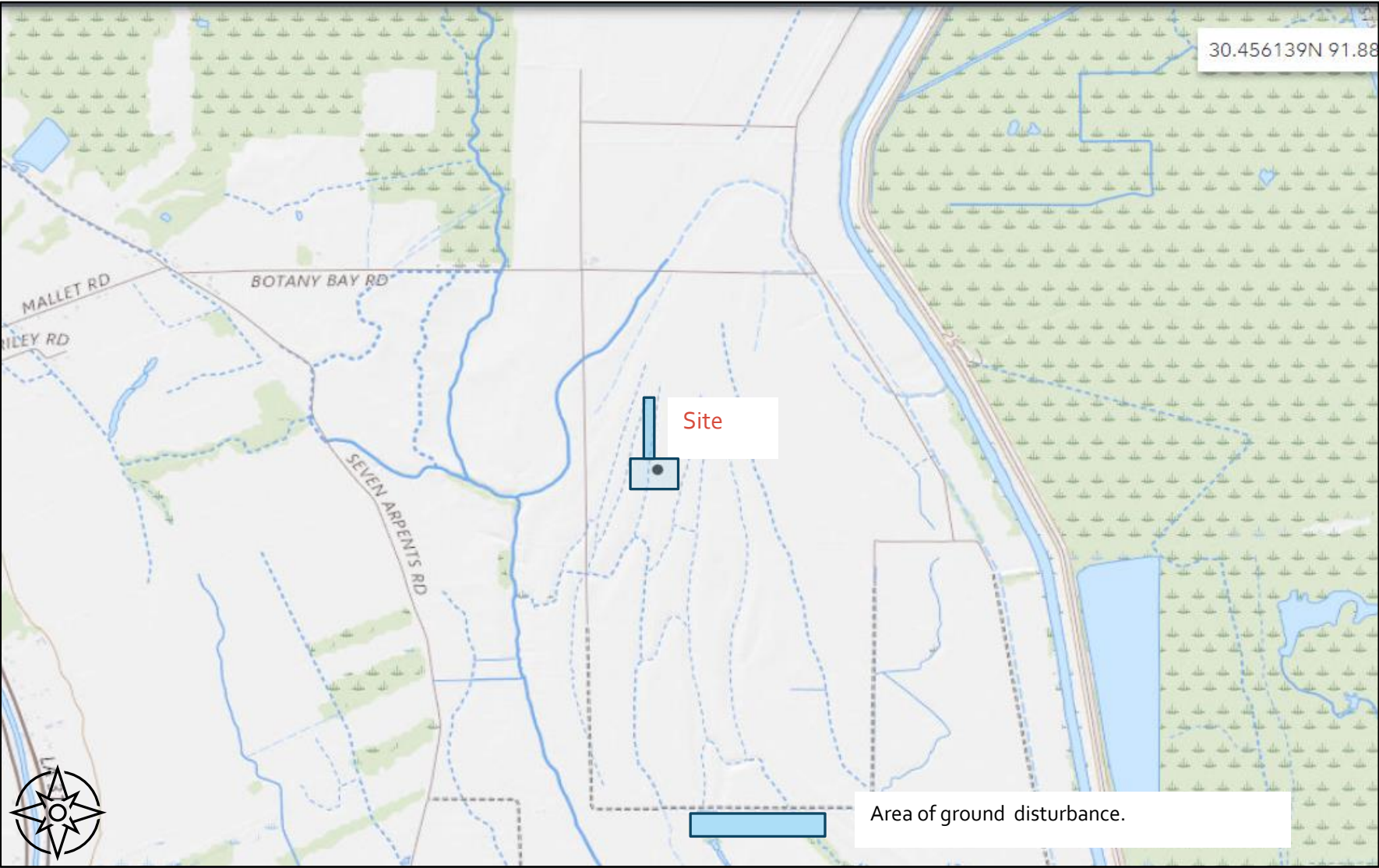

APE for Visual Effects

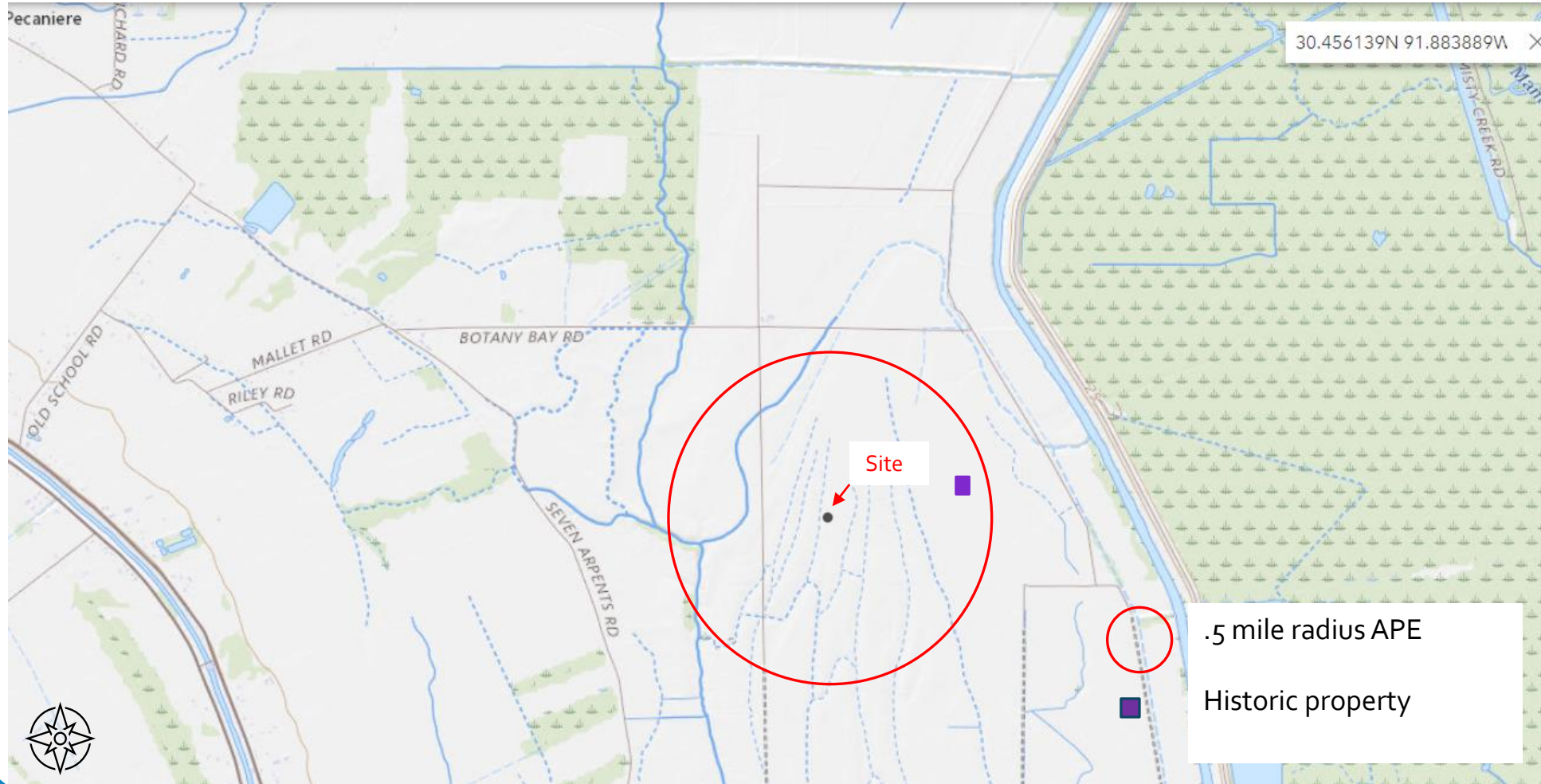

Key Photographs

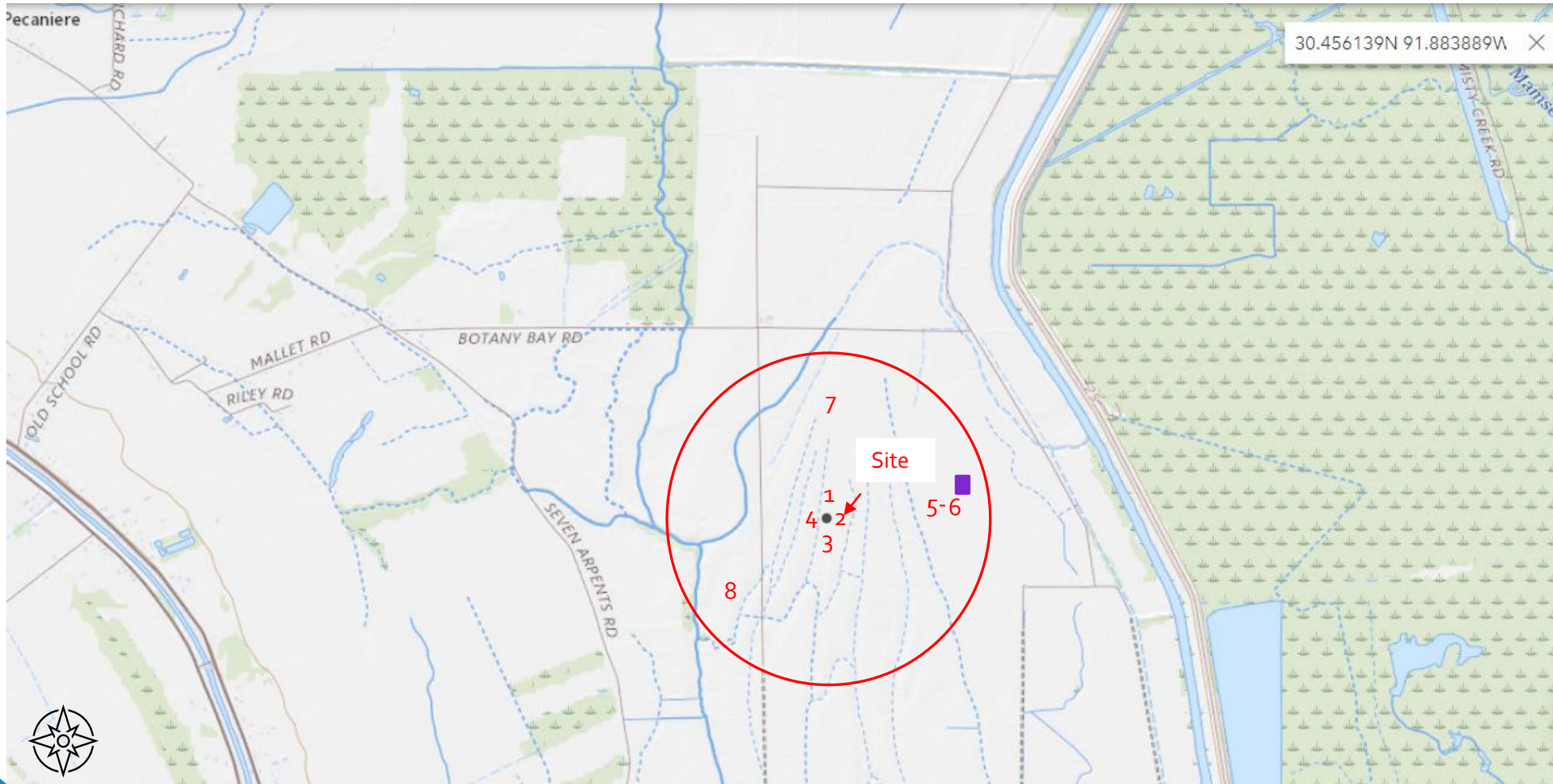

Per the Form 620 Instructions: "photographs should be in color, marked so as to identify the project, keyed to the relevant map".

Additional Site Information

- Additional Site Information Recommendations:
 - Describe any additional structures, access roads, utility lines, fences, easements, or other construction planned for the site in conjunction with the proposed tower and related facilities. Use this attachment to provide additional details needed to provide a full and accurate description of any structural alterations, additions, or other construction activities that will take place to complete the tower.
 - Site plans are usually included in this attachment and are extremely helpful in visualizing the proposed work.
 - Site plans that depict building or non-tower structures for collocations (before and after) significantly aide in the review process.



Tribal/Native Hawaiian Organization Involvement

- Please include relevant documents pertaining to Tribal Consultation.
- Acceptable documents can include but are not limited to:
 - Copies of emails
 - Copies of letters
 - Attaching the Notice of Organizations.
- Applicants/consultants should take care to not disclose locations of Tribal significance.

Historic Properties for Direct Effects

- Clearly describe the APE for Direct Effects.
- The APE for direct effects is limited to the area of potential ground disturbance and any property, or any portion thereof, that will be physically altered or destroyed by the Undertaking.
- Pursuant to Section VI.D.2.a. of the NPA, applicants shall make a reasonable and good faith effort to identify above ground and archaeological historic properties, including buildings, structures, sites, objects, and historic districts, that lie within the APE for direct effects.
- Such reasonable and good faith efforts may include a field survey where appropriate.
- Pursuant to Section VI.D.2.b of the NPA, identification and evaluation of Historic Properties within the APE for direct effects, including any finding that an archeological Field Survey is not required, shall be undertaken by a professional who meets the Secretary of the Interior's Professional Qualification Standards.
- Under Section VI.D.2.d. of the NPA, an archeological field survey is required if an Indian Tribe or Native Hawaiian Organization provides evidence that supports a high probability of the presence of intact archeological Historic Properties within the APE for direct effects.

Historic Properties for Direct Effects

- List all properties identified within the APE for direct effects.
 - Provide the name and address (including U.S. Postal Service ZIP Code) of each property in the APE for direct effects, not listed in part “a”, that the Applicant considers to be eligible for listing in the National Register as a result of the Applicant’s research. For each such property, describe how it satisfies the criteria of eligibility (36 CFR Part 63). For each property that was specifically considered and determined not to be eligible, describe why it does not satisfy the criteria of eligibility.
- Describe the techniques and the methodology, including any field survey, used to identify historic properties within the APE for direct effects.
- If no archeological field survey was performed, provide a report substantiating that: i) the depth of previous disturbance exceeds the proposed construction depth (excluding footings and other anchoring mechanisms) by at least 2 feet; or ii) geomorphological evidence indicates that cultural resource-bearing soils do not occur within the project area or may occur but at depths that exceed 2 feet below the proposed construction depth.

Historic Properties for Visual Effects

- Section VI.D.1.a. of the Nationwide Programmatic Agreement requires the applicant to review publicly available records to identify within the APE for visual effects:
 - i) properties listed on the National Register;
 - ii) properties formally determined eligible for listing by the Keeper of the National Register;
 - iii) properties that the SHPO/THPO certifies are in the process of being nominated to the National Register; and
 - iv) properties listed in the SHPO/THPO Inventory that the SHPO/THPO has previously evaluated and found to meet the National Register criteria, and that are identified accordingly in the SHPO/THPO Inventory.
- Section VI.D.1.a also requires the Applicant to identify historic properties that have religious or cultural significance to Tribes and Native Hawaiian Organizations.

Identification of Historic Properties

Section VI.D.1.c. of the NPA states:

c. Based on the sources listed above and public comment received pursuant to Section V of this Nationwide Agreement, the Applicant shall include in its Submission Packet a list of properties it has identified as apparent Historic Properties within the APE for visual effects.

i. During the review period described in Section VII.A, the SHPO/THPO may identify additional properties included in the SHPO/THPO Inventory and located within the APE that the SHPO/THPO considers eligible for listing on the National Register, and notify the Applicant pursuant to Section VII.A.4.

ii. The SHPO/THPO may also advise the Applicant that previously identified properties on the list no longer qualify for inclusion in the National Register.

Local Government Involvement

- If any local government has been contacted and invited to become a consulting party pursuant to Section V.A. of the Nationwide Agreement, list the local government agencies contacted. Provide a summary of contacts and copies of any relevant documents (*e.g.*, correspondence or notices).
- If a local government agency will be contacted but has not been to date, explain why and when such contact will take place.

Public Involvement

The Submission Packet should include the following:

- Copies of any relevant correspondence or other documentation used to invite public involvement in this project (*e.g.*, legal notices, letters, or public meetings);
- Either a copy of the public notice (after publication) or an affidavit will satisfy this requirement; and
- Any comments received.

C and O Cellular Company intends to construct a communications facility or tower at 123 W Country Road, St Martins Parish, Greenfield, LA 70005 (30°27'22.1" N 91°53'02.0" W). [The proposed tower is a 199- foot self-support lattice tower. C and O Cellular is publishing this notice in accordance with Federal Communications Commission regulations (47 CFR Pt. 1, Appx. C, § V.C. and 47 CFR § 1.1307) implementing Section 106 of the National Historic Preservation Act and the National Environmental Policy Act. Parties interested in commenting on this Federal undertaking or with questions on the proposed facility should contact Max Smith at M and M Environmental Consultants, Inc 456 Main Street, Springfield, Louisiana 70001. Phone: 318-789-1234 Email: msmith@mandmconsult.com

State-Specific Forms

- A state-specific form may or may not be required.
- State-specific forms do not substitute the need for a complete Form 620/621.

Resources

- Instructions for filling out Forms 620/621 can be found on the FCC's Tower and Antenna Siting Page: <https://www.fcc.gov/wireless/bureau-divisions/competition-infrastructure-policy-division/tower-and-antenna-siting>
- [Form 620 Instructions](#)
- [Form 621 Instructions](#)
- [Local Public Notice Template](#)